

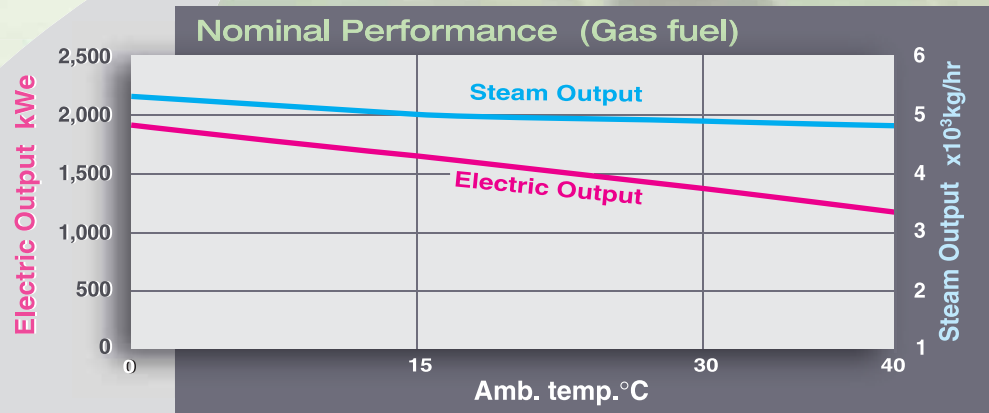

High efficiency : electric 26.0%, overall 80.1%  
 Dry low emissions : NOx 9/15ppmv, CO 50ppmv ( O<sub>2</sub> = 15% )  
 High reliability & easy maintenance



Amb. temp. °C (°F)	Electric Output kWe	Heat Rate kJ/kWe-hr	Steam Output x10³kg/hr	Electrical Efficiency %	Total Thermal Efficiency %
0 (32)	1,910	13,160	5.2	27.4	77.8
15 (59)	1,630	13,870	5.0	26.0	80.1
40 (104)	1,200	15,910	4.8	22.6	83.6

**Nominal Performance**

Elevation : 0 m  
 Inlet Air Temperature : 15 °C  
 Inlet Air Pressure Loss : 0.98 kPa  
 Exhaust Gas Pressure Loss : 2.45 kPa  
 LHV of Natural Gas Fuel : 35.9 MJ/Nm<sup>3</sup>  
 (100% CH<sub>4</sub>)

**Typical Steam Condition**

Steam Pressure : 0.83 MPaG  
 Steam Temperature (Saturated) : 177 °C  
 Feed Water Temperature : 80 °C  
 Blowdown from HRSG : 0 %

### ● Typical system flow ( IN CASE OF GAS FUEL)

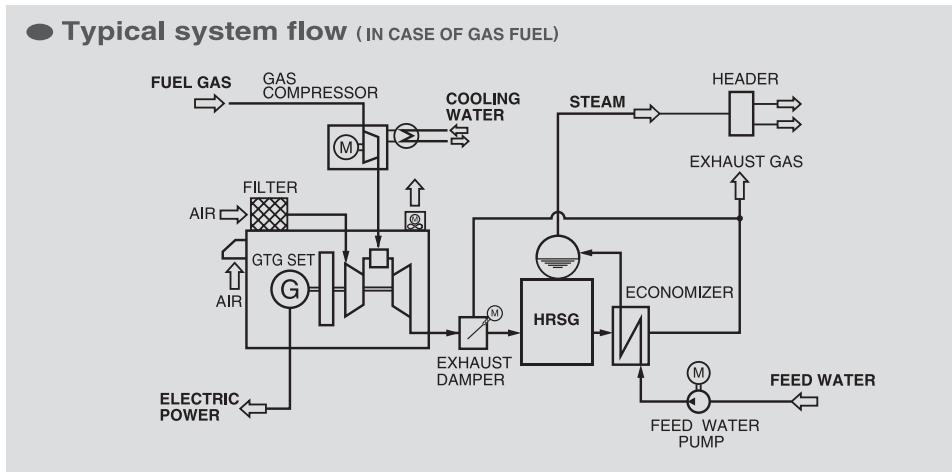

### ● Typical layout (Unit:mm)

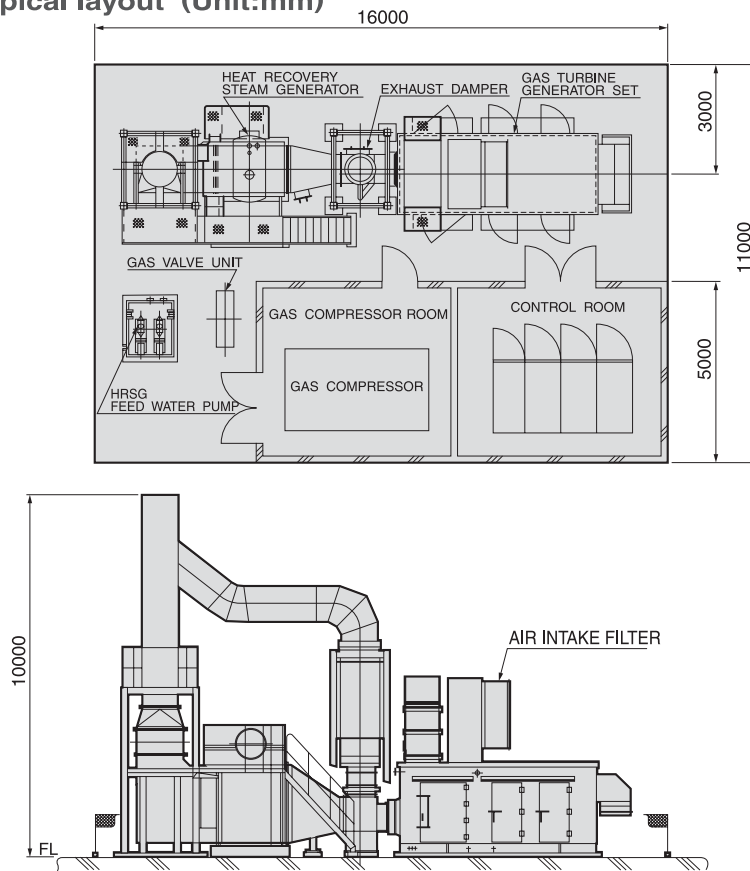

[www.khi.co.jp/english/gasturbine/index.html](http://www.khi.co.jp/english/gasturbine/index.html)

**Kawasaki Heavy Industries, Ltd. Gas Turbine Division**

Phone: +81-3-3435-2579 Fax: +81-3-3435-2592

**Kawasaki Machine Systems, Ltd. (Asia Division)**

Phone: +81-3-3435-2977 Fax: +81-3-3435-2592

**Kawasaki Gas Turbine Asia Sdn Bhd : (KGA)**

Phone: +60-3-7846-2882 Fax: +60-3-7848-3093

[www.kga.com.my](http://www.kga.com.my)

**Kawasaki Gas Turbine Europe GmbH : (KGE)**

Phone: +49-6172-7363-0 Fax: +49-6172-7363-55

[www.kawasaki-gasturbine.de](http://www.kawasaki-gasturbine.de)

**Kawasaki Gas Turbines-Americas : (KGT-A)**

Phone: +1-281-970-3255 Fax: +1-281-970-6465

[www.kawasakigasturbines.com](http://www.kawasakigasturbines.com)

**Kawasaki Machine Systems, Ltd. (Shanghai Rep.Office)**

Phone: +86-21-3366-3500 Fax: +86-21-3366-3505

**Kawasaki Heavy Industries Middle East FZE : (KHI-ME)**

Phone: +971-4-214-6727 Fax: +971-4-214-6729

**Kawasaki Gas Turbines-Americas  
(Houston, TX)**

**Kawasaki Gas Turbine Europe GmbH  
(Frankfurt, Germany)**

**Kawasaki Heavy Industries, Ltd.  
(Tokyo, Japan)**

**Kawasaki Machine Systems, Ltd.  
(Shanghai Rep. Office)**

**Kawasaki Heavy Industries  
Middle East FZE  
(Dubai, UAE)**

**Kawasaki Gas Turbine Asia Sdn Bhd  
(Shah Alam, Malaysia)**

